

Astley & co

ESTATE AGENTS



6 Heath Road
Norwich

Price: Guide Price
£239,950

Information

Two of Everything - Walk-in Mid Terraced House with Two Bedrooms, Two Reception Rooms and Two Bathrooms.

Very well presented with an extended Kitchen making better use of the outside space and incorporating a Velux window to bring in maximum light.

The upstairs bathroom enjoys a luxury freestanding roll top bathtub. Lots of lovely features.

Walking distance to the City centre.

Gas Fired Central heating. Energy Performance Rating D

6 Heath Road

Norwich

Price Guide Price £239,950

Astley & Co
ESTATE AGENTS

Description

Lounge 11' 6" x 11' 6" (3.5m x 3.5m)

Dining Room 11' 6" x 10' 6" (3.5m x 3.2m)

Kitchen 11' 6" x 8' 2" (3.5m x 2.5m)

Bathroom 6' 7" x 5' 7" (2.0m x 1.7m)

Bedroom 1 11' 6" x 11' 6" (3.5m x 3.5m)

Bedroom 2 11' 6" x 10' 6" (3.5m x 3.2m)

En-suite 7' 10" x 6' 7" (2.4m x 2.0m)

Courtyard Garden

Summary of accommodation

- Mid Terrace House
- Two Bedrooms
- Two Bathrooms
- Extended Kitchen with Skylight
- South Facing Courtyard Non-Bisected Garden
- Gas Fire & Gas Central Heating

Score	Energy rating	Current	Potential
92+	A		
81-91	B		88 B
69-80	C		
55-68	D	68 D	
39-54	E		
21-38	F		
1-20	G		

Astley & Co Estate Agents

Email: yvonne@astleyandco.com

Website: www.astleyandco.com

Tel: 01603 415182

Fax:

GROUND FLOOR
501 sq.ft. (46.6 sq.m.) approx.

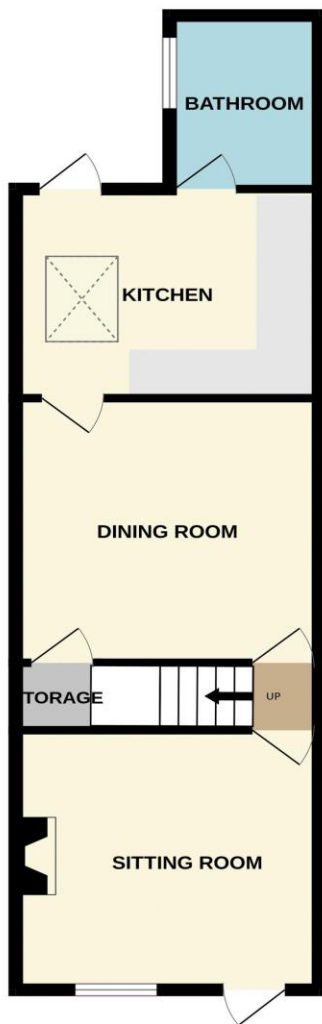

1ST FLOOR
400 sq.ft. (37.2 sq.m.) approx.

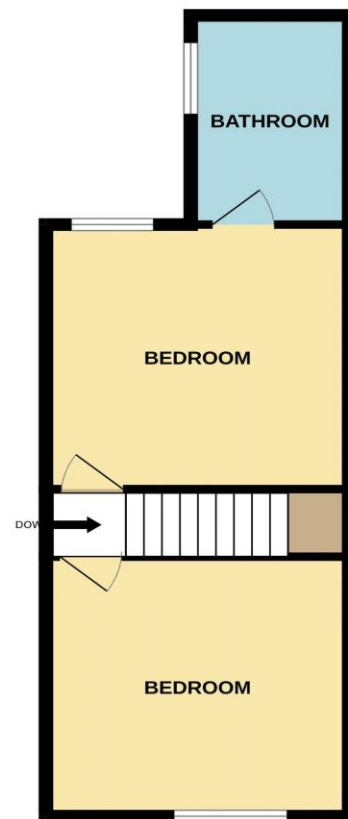

TOTAL FLOOR AREA : 902 sq.ft. (83.8 sq.m.) approx.

Whilst every attempt has been made to ensure the accuracy of the floorplan contained here, measurements of doors, windows, rooms and any other items are approximate and no responsibility is taken for any error, omission or mis-statement. This plan is for illustrative purposes only and should be used as such by any prospective purchaser. The services, systems and appliances shown have not been tested and no guarantee as to their operability or efficiency can be given.
Made with Metropix ©2024

